

amer  
— YACHTS —



ÄLTVS | Amer F100













AMER0100D

























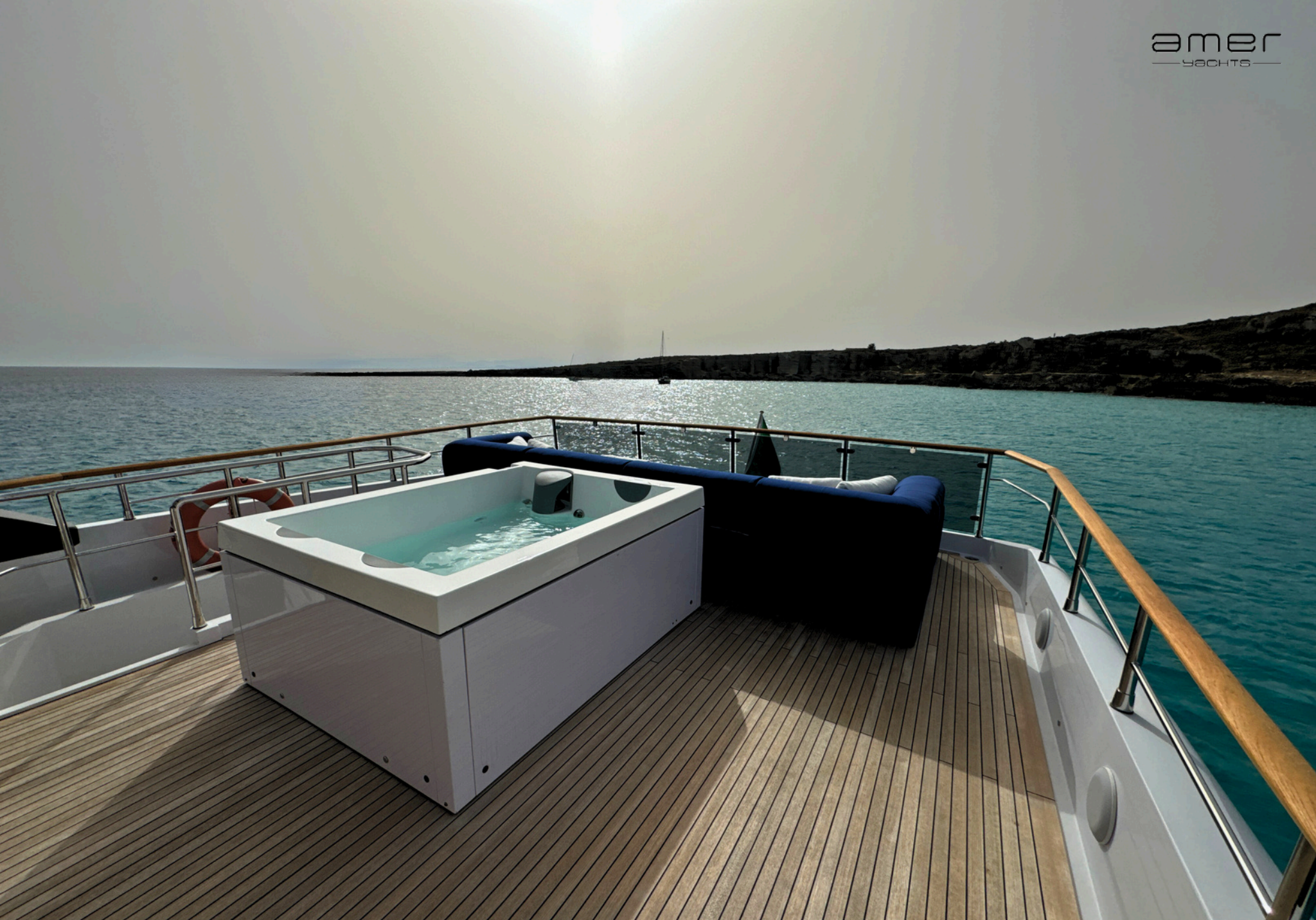



















































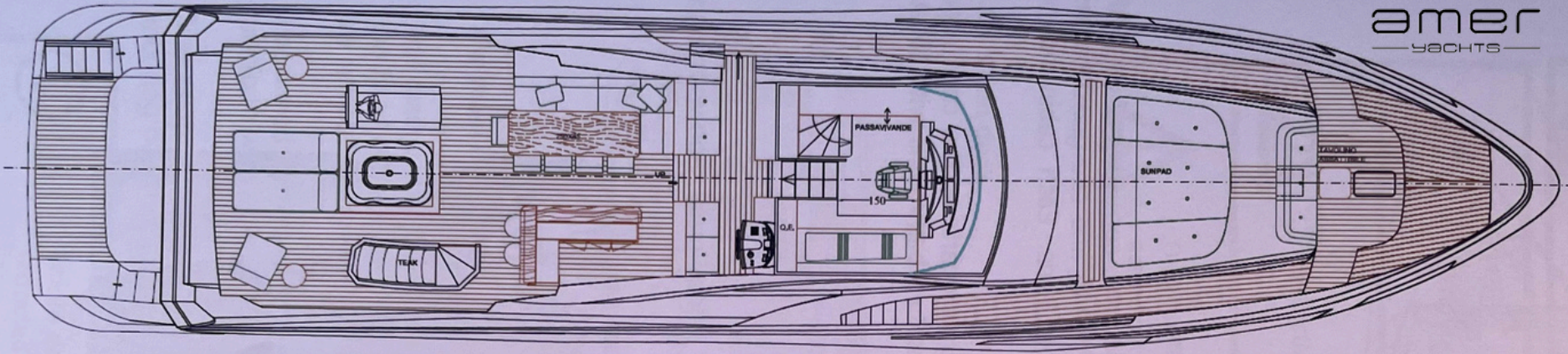

Fly Deck

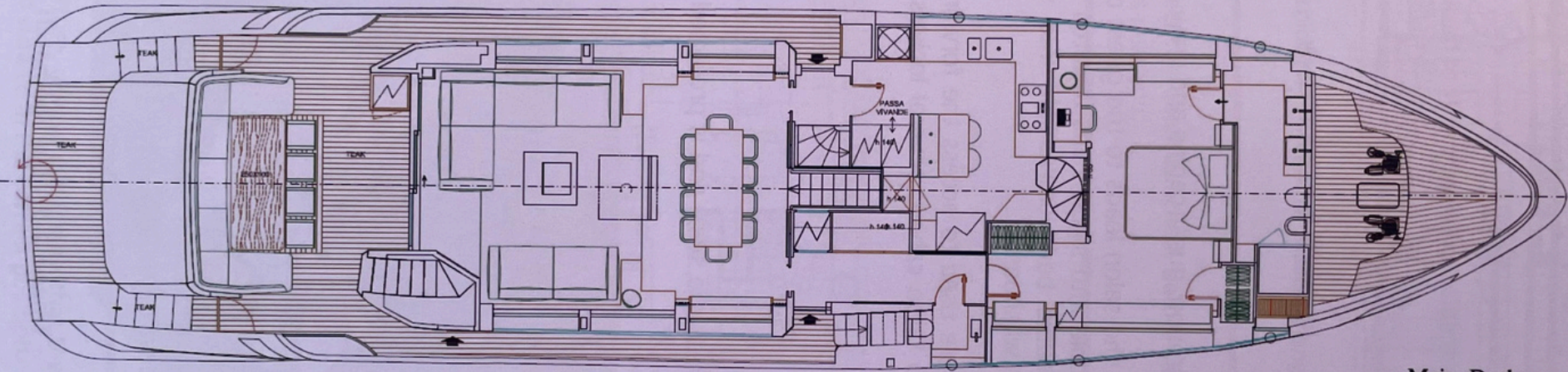

Main Deck

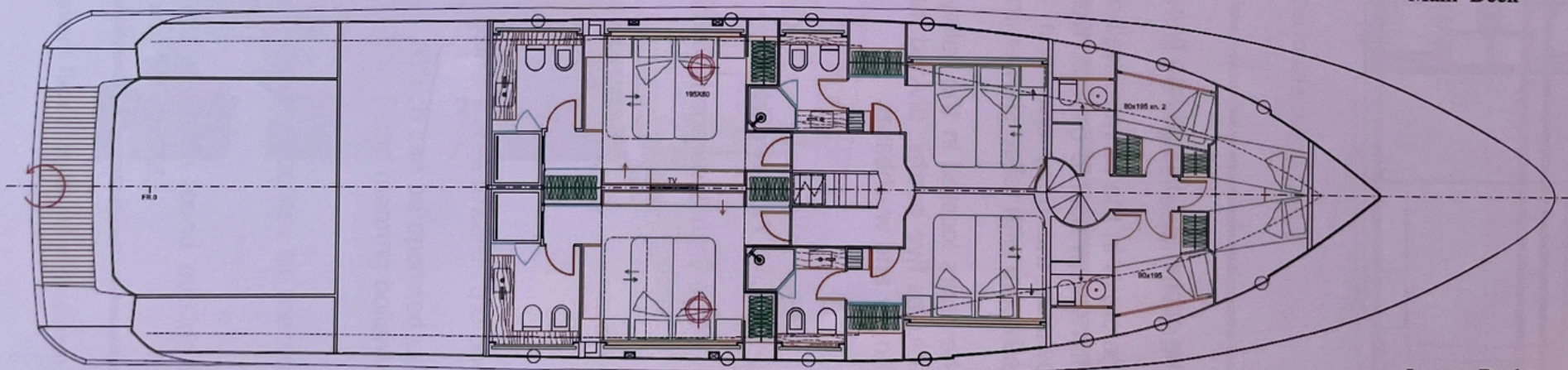

Lower Deck

Figure 3-1 – General Plans



CREW: **CAPTAIN + 4**



GUESTS CRUISING: **12**

GUESTS SLEEPING: **10**

NUMBER OF CABINS: **5**



1 - MASTER CABIN WITH KING BED AND ENSUITE BATHROOM

2 - VIP CABINS WITH DOUBLE BED AND ENSUITE BATHROOM

2 - DOUBLE CABINS WITH DOUBLE (CONVERTIBLE) BEDS ENSUITE BATHROOM



TOYS: **2 SEABOBS, SUP, TENDER**

**AERMARINE 420 SUZUKY 40**

**SNORKELING EQUIPMENT,**

**INFLATABLES, GYM EQUIPMENT**

BUILDER: **AMER**

MODEL: **F100**

YEAR : **2020 ( REFIT 2024)**

LOA: **29.90 M**

BEAM: **7.00 M**

DRAFT: **1.95 M**

ENGINE: **4 X VOLVO PENTA IPS 1200 HP**

CRUISING SPEED: **23 KNOTS**

MAXIMUM SPEED: **30 KNOTS**

#### KEY FEATURES:

- DOUBLE STABILIZERS
- 5 COMFORTABLE CABINS
- ECONOMICAL CRUISE
- STARLINK WI-FI CONNECTION